

Drain: PARK NORTHWESTERN DRAIN **Drain #:** 136
Improvement/Arm: PARK NORTHWESTERN - RELINQUISH
Operator: JOH **Date:** 8-12-04
Drain Classification: Urban/Rural **Year Installed:** 1999

GIS Drain Input Checklist

- Pull Source Documents for Scanning JD
- Digitize & Attribute Tile Drains N/A
- Digitize & Attribute Storm Drains JD
- Digitize & Attribute SSD JD
- Digitize & Attribute Open Ditch JD
- Stamp Plans JD
- Sum drain lengths & Validate JD
- Enter Improvements into Posse JD
- Enter Drain Age into Posse _____
- Sum drain length for Watershed in Posse _____
- Check Database entries for errors JD

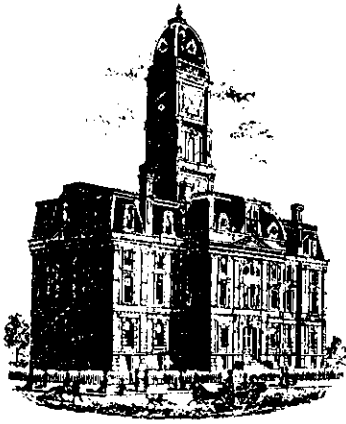

SURVEYOR'S OFFICE
Hamilton County

Kenton C. Ward, Surveyor

Phone (317) 776-8495

Fax (317) 776-9628

Suite 146

One Hamilton County Square

Noblesville, Indiana 46060-2230

To: Hamilton County Drainage Board

July 15, 1999

Re: Park Northwestern Drain

Attached are plans and the schedule of assessments for the reconstruction of the Park Northwestern Drain.

This Drain was constructed originally in 1980 and is currently on a maintenance program. Reconstruction is required at this time due to the siltation of the swale and detention area, failure of the subsurface drain and the proposed reconstruction of St. Rd. 421.

The reconstruction will consist of the following items:

- A. Installing 8" subsurface drain from the North side of Northwestern Drive through the detention area and outletting on the West side of the basin into the 27" RCP installed as part of the drainage system for Mayflower Transit in Boone County.
- B. Installing a 43" x 27" RCP under Northwestern Drive to replace the existing pipe.
- C. Install twin 27" RCP's as outlets to the detention area.
- D. Regrade open ditch and detention area North of Northwestern Drive.

Items B and C are needed in order to provide for the additional flows for the proposed reconstruction of S.R. 421.

The cost estimate for the work is as follows:

Item Installed	Quantity	Unit Cost	Total Cost
8" dual wall perforated plastic tile installed with #8 stone bedding	1,280 LFT	\$9.00 LFT	\$11,520.00
8" risers with beehive casting	2	\$200.00 ea.	\$ 400.00
Core 27" RCP for the 8" SSD	1	\$250.00 ea.	\$ 250.00
Regrading ditch and leveling spoils	1,290 LFT	\$ 6.00/LFT	\$ 7,740.00
Seeding	4 ac.	\$1,000.00/ac.	\$ 4,000.00
Reno mattress with Rip Rap	85 tons	\$ 36.00/ton	\$ 3,060.00
Contingencies	15%	\$85,350.00	\$12,803.00
<u>State Highway</u>			
43" x 27" RCP pipe installed with #8 stone bedding	440 LFT	\$75.00/LFT	\$33,000.00
43' x 27" RCP pipe endsections installed with #8 stone bedding	4	\$1,750.00 ea.	\$ 7,000.00
Bituminous street repair For Northwestern Drive	116 SYS	\$105.00/SYS	\$12,180.00
27" RCP pipe installed with #8 stone bedding	80 LFT	\$ 65.00/LFT	\$ 5,200.00
18" RCP pipe installed with #8 stone bedding	25 LFT	\$ 20.00/LFT	\$ 500.00
2' x 2' box with beehive casting installed	1	\$500.00 ea.	\$ 500.00
Total Cost Estimate			\$98,153.00
State Highway-Special assessment			\$58,380.00

Due to the project being within already platted easements, no damages to landowners will result by the reconstruction of this drain. Therefore, damages shall be set at \$0.00.

The cost of the new pipe under Northwestern Drive; the new 27" pipe at the county line and the 18" pipe South of Northwestern Drive is due to the State's proposed reconstruction of S.R. 421 and the higher rates of flow which will result because of the work. Therefore, the cost of this work, \$58,380.00, shall be assessed to the State Highway as a special assessment.

The remainder of the cost, \$39,773.00 shall be spread over the entire drainage shed. I have reviewed the plans and believe the drain will benefit each tract equally. Therefore, I recommend each tract be assessed equally. I recommend each tract within the drainage shed be assessed \$230.00 per acre without a minimum assessment for reconstruction.

Currently the drain is assessed for maintenance at a rate of \$20.00 per acre, \$20.00 minimum which brings in \$2,282.40 annually. Current balance in the maintenance fund is \$7,710.12. Therefore, I recommend no increase in the annual maintenance assessment.

I believe this proposed drain meets the requirements for Urban Drain Classification as set out in IC 36-9-27-67 to 69. Therefore, this drain shall be designated as an Urban Drain.

I recommend a hearing be set for this proposal on August 23, 1999.

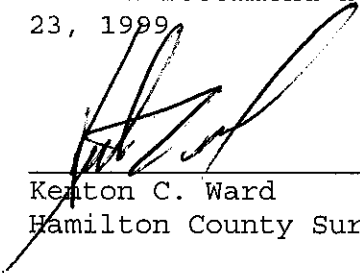

Kenton C. Ward
Hamilton County Surveyor

KCW/llm

STATE OF INDIANA)
) ss:
COUNTY OF HAMILTON)

BEFORE THE HAMILTON COUNTY
DRAINAGE BOARD
NOBLESVILLE, INDIANA

IN THE MATTER OF THE
RECONSTRUCTION OF THE
Park Northwester Drain

FINDINGS AND ORDER FOR RECONSTRUCTION

The matter of the proposed Reconstruction of the *Park Northwester Drain* came before the Hamilton County Drainage Board for hearing on **August 23, 1999**, on the Reconstruction Report consisting of the report and the Schedule of Damages and Assessments. The Board also received and considered the written objections of owners of certain lands affected by the proposed Reconstruction, said owners being:

Evidence was heard on the Reconstruction Report and on the aforementioned objections.

The Board, having considered the evidence and objections, and, upon motion duly made, seconded and unanimously carried, did find and determine that the costs, damages and expenses of the proposed Reconstruction will be less than the benefits accruing to the owners of all land benefited by the Reconstruction.

The Board having considered the evidence and objections, upon motion duly made, seconded and unanimously carried, did adopt the Schedule of Assessments as proposed, subject to amendment after inspection of the subject drain as it relates to the lands of any owners which may have been erroneously included or omitted from the Schedule of Assessments.

The Board further finds that it has jurisdiction of these proceedings and that all required notices have been duly given or published as required by law.

Wherefore, it is ORDERED, that the proposed Reconstruction of the ~~Spring Mill Run~~ Drain be and is hereby declared established.
Park Northwestern

Thereafter, the Board made inspection for the purpose of determining whether or not the lands of any owners had been erroneously included or excluded from the Schedule of Assessments. The Board finds on the basis of the reports and findings at this hearing as follows:

HAMILTON COUNTY DRAINAGE BOARD

PRESIDENT

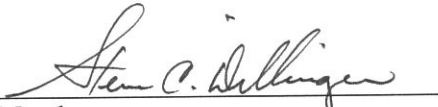
Member

Member

ATTEST:

Executive Secretary

BEFORE THE HAMILTON COUNTY DRAINAGE BOARD
IN THE MATTER OF
Park Northwestern-Reconstruction

NOTICE

To Whom It May Concern and: _____

Notice is hereby given of the hearing of the Hamilton County Drainage Board on the Park Northwestern Drain on August 23, at 9:15 A.M. in Commissioners Court, Hamilton County Judicial Center, One Hamilton County Square, Noblesville, Indiana, and which construction and maintenance reports of the Surveyor and the Schedule of Assessments made by the Drainage Board have been filed and are available for public inspection in the office of the Hamilton County Surveyor.

Hamilton County Drainage Board

Attest: Kimberly Wallace

ONE TIME ONLY

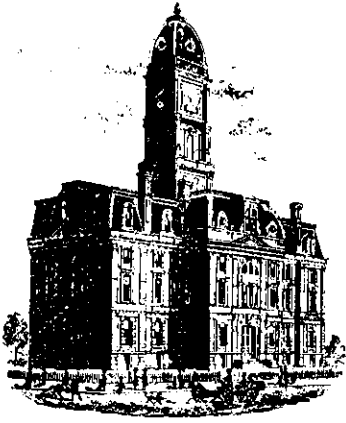

SURVEYOR'S OFFICE

Hamilton County

Kenton C. Ward, Surveyor

Phone (317) 776-8495

Fax (317) 776-9628

Suite 146

One Hamilton County Square
Noblesville, Indiana 46060-2230

To: Kent Ward
Hamilton County Surveyor

RE: Park Northwestern Reconstruction

FINAL INSPECTION REPORT

Please regard this letter as the Inspector's Final Report on the Park Northwestern Regulated Drain Reconstruction, located in Section 7, Township 17 North, Range 3 East in Clay Township in Hamilton County. As of the date above I do hereby attest to and agree that the design plans and additional change order has been done by Corbitt & Sons Construction.

All grade checks and asbuilts have been completed by this Office. All other inspections have been performed by myself. Notarized statement of all expenses incurred for labor and materials paid and received. All Claims have been paid, the retainage from these claims will be held until seed germination has occurred or reseeding is done in the spring of 2000!

Claim Order #1	\$74,532.25
Retainage	+\$13,152.75
Total	\$87,685.00
Change Order #1	\$1275.00
Retainage	+\$225.00
Total	\$1,500.00
Claim Order #1	\$74,532.25
Change Order #1	+\$1,275.00
Total Claim Orders	\$75,807.25
Total Claim Orders	\$75,807.25
Total Amount Retained	+\$13,377.75
Total Reconstruction Cost	\$89,185.00
Total Reconstruction Cost	\$89,185.00
Contractor's Bid	\$87,685.00
Difference In Cost Due To Change Order	\$1,500.00

Engineers Estimate-----	\$98,153.00
Claims Paid to Date-----	\$75,807.25
Retainage-----	\$13,377.75
Difference between Engineer's and Contractor's Cost-----	\$8,968.00

Sincerely,

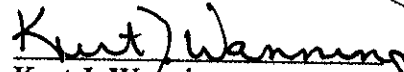

Kurt J. Wanninger,
Permit Inspector

Park Northwestern Asbuilt

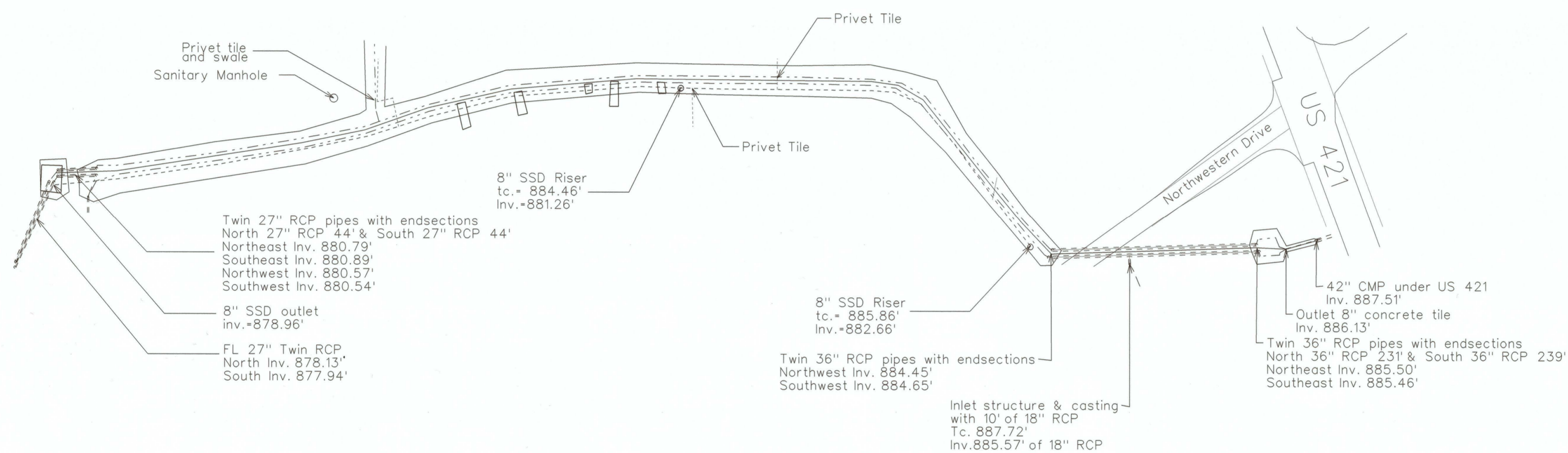

PLAN VIEW

SCALE 1" = 100'

HAMILTON COUNTY, INDIANA
 Hamilton County Surveyor's Office
 Hamilton County Government and
 Judicial Center
 One Hamilton County Square, Suite 188
 Noblesville, IN 46060
 (O) 776-8495
 (F) 776-9628
 surveyor@co.hamilton.in.us

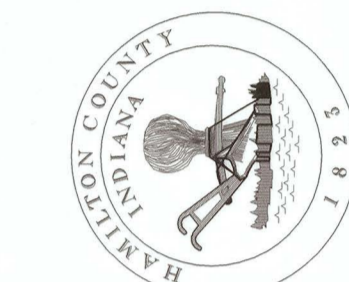

Project No:	Watershed No:
By:	Dgn Name:
Date:	Field By:
Revisions:	Drawn By:
	Checked By:
	Date:



Certified By:
Jeffrey P. Powell
 Jeffrey P. Powell

Project Name:	Park Northwestern Asbuilt
	Asbuilt

SHEET NO.